

KNO20-B-PP

直线球轴承

舍弗勒ID：
0193233870000

技术信息

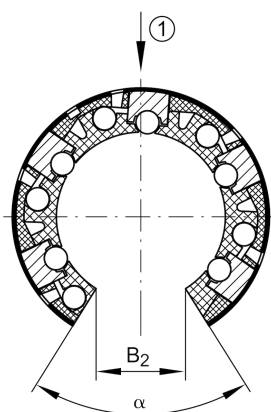
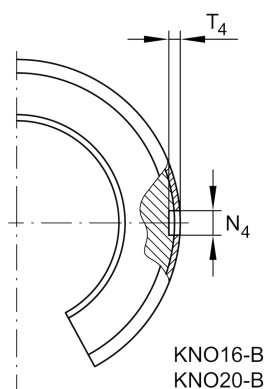

主要尺寸和性能数据

F_w	20 mm	Bore diameter of ball complement
D	32 mm	Outside diameter
L	45 mm	length
C_{max}	1,740 N	load capacity dyn.
C_{0max}	1,240 N	load capacity stat.
	50 g	重量

安装尺寸

B_2	9 mm	Width of sector opening
T_4	0.9 mm	
N_4	3 mm	
α	55 °	Angle of sector opening
b_{1max}	2.5 mm	
	5	Number of rows balls

